



A SecureAuth Company

**Next Generation Authentication Is Streaming!**  
**Passwordless Continuous Auth.**



# Agenda

- Authentication A Single Event Or A Continuum?
  - Binary Auth Is Like a Bad Habit
  - All Evil Happens Post-Authorization
- Overview of the limitations of conventional binary authentication
  - MFA Fatigue
  - Where Is Your Enterprise On Authentication Spectrum
- Discuss the trifecta of benefits of Next Generation Continuous Authentication
  - Lower Cost
  - Lower Friction
  - Passwordless: Higher Security
- Behavioral-Based Authentication Architecture Overview
- Team Discussion: “We have seen a thing or two”:

Authentication Is Not A Single Event,  
With A Password And A Binary MFA  
**But A Continuum**



# USING LEGACY AUTHENTICATION TECHNOLOGIES WHICH FALL SHORT IS HIGH RISK!



Passwords present **friction**  
Inherently **insecure** and could be **stolen**  
**Costly** to maintain and reset



Password managers only help with "forgot passwords"  
Require individual adoption

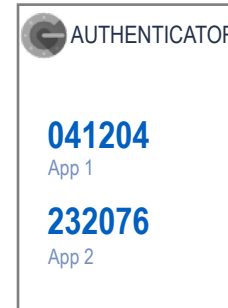
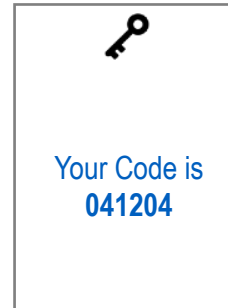
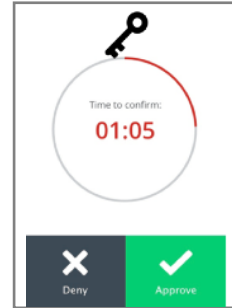

2<sup>nd</sup> factor token adds **friction**  
**Does not protect user from stolen device, SIM-swapping**

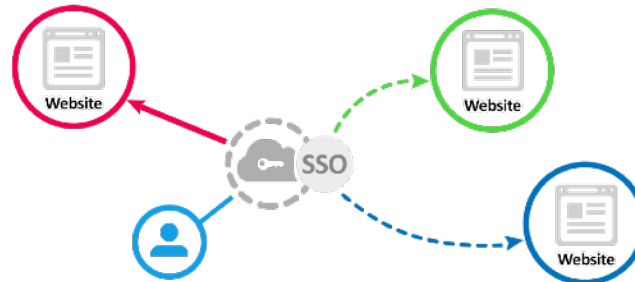

SSO reduces friction  
**Does not increase security** or protection



# Binary Auth Is Like A Bad Habit

## Unlearning Bad Habits Is Hard

**Psychologists have simple trick to advanced models to enable learning good habits and unlearning bad habits:** For any activity, our brain comprehends it as "trigger, behavior, reward". Idea is to continuously develop multiple triggers to perform the same activity securely. And we detect and recognize it to a point we recognize anomalies when faked.

Should Access and Control become smarter and do the same?



# And All Evil happens Post-Authorization

81% of all data breaches are caused by passwords

\$8.2M average cost of a data breach in the US

1/3 of data breach costs continued after 1yr post breach

Resetting passwords could cost up to \$50 per user per incident



Log In

Create Account

**WATCH & SAY NO TO CRAZY SOLUTIONS LIKE THIS!**

The most secure,  
**friction-filled** password  
manager of all time.

11 Factor remembers all your passwords for you, and  
then makes it basically **impossible for anyone**  
**(including you) to retrieve them.**

LEARN MORE

Get Started

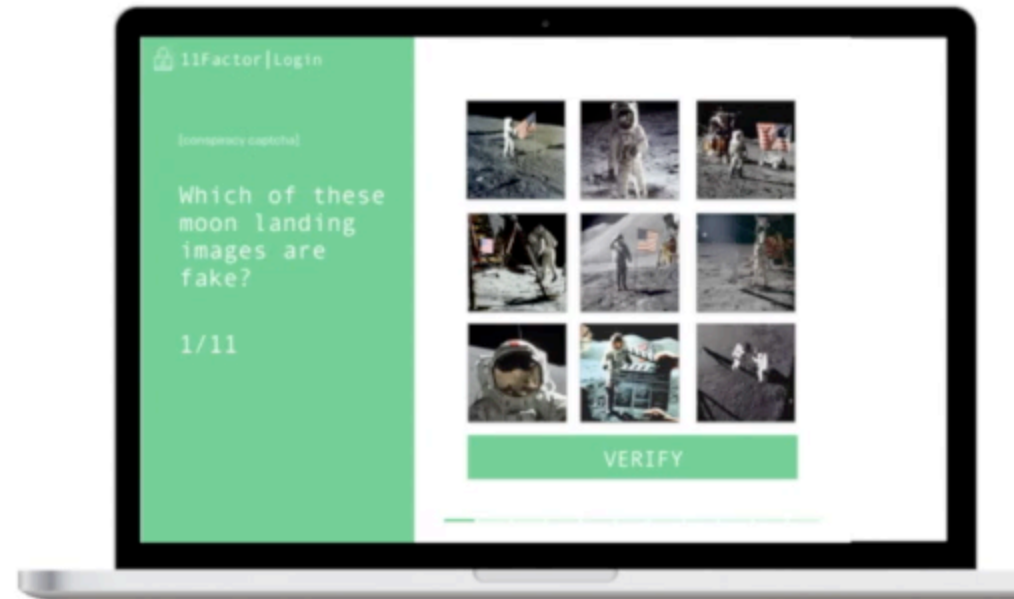

# Authentication Spectrum:

What Assets Your Enterprise Has Today vs. Needs To Acquire In The Next 1-5 Years?

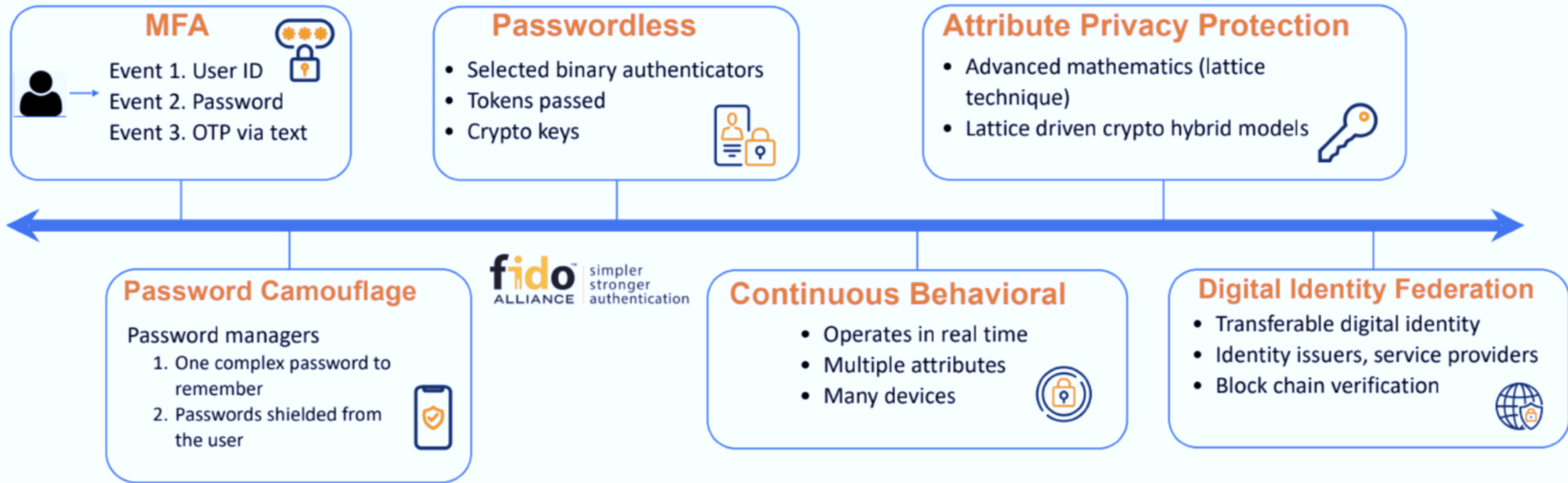



# TRIFECTA OF LOWER COST, LOWER FRICTION AND HIGHER SECURITY:

DATA SCIENCE IS THE HOLY GRAIL OF NEXT GENERATION AUTHENTICATION

## Security Maturity Model

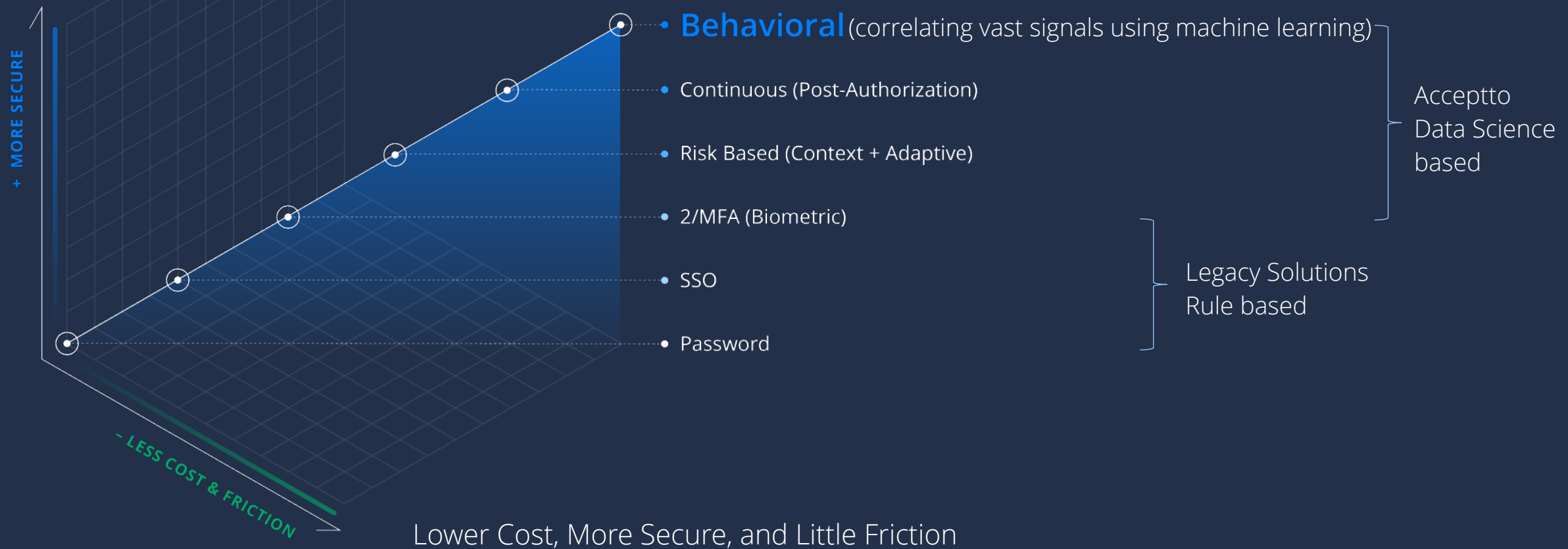

# AIML DELIVERS UNMATCHED VISIBILITY vs LEGACY BINARY APPROACH?



What Acceptto sees

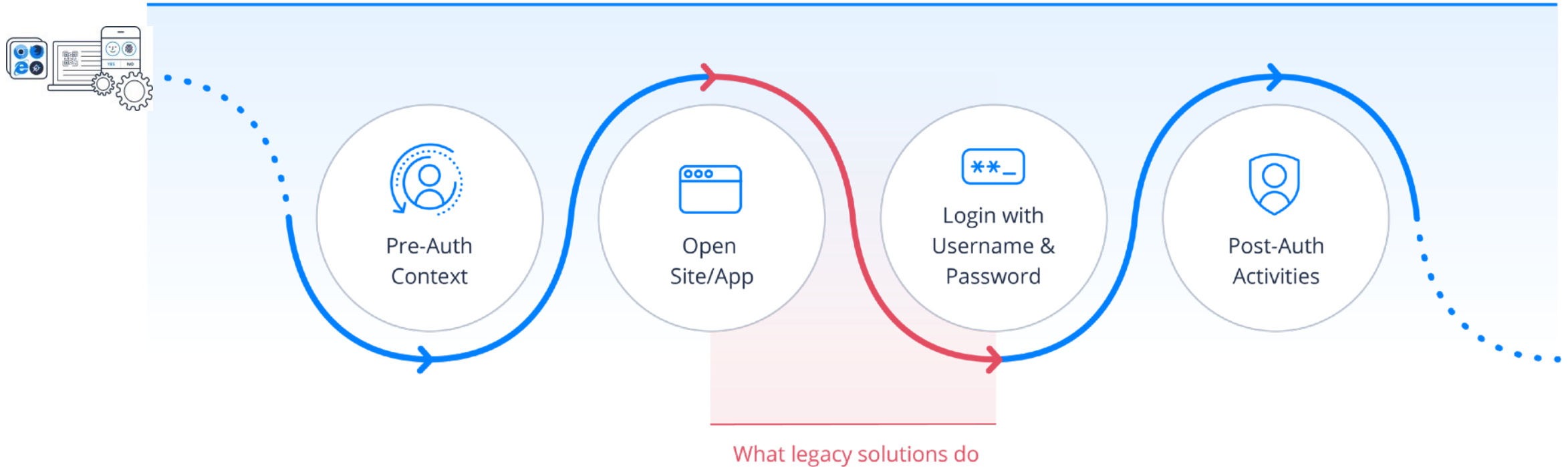

# CONTINUOUS AUTHENTICATION: CROSSING LOGICAL & PHYSICAL BOUNDARIES



**Patent-backed machine learning algorithms that enrich authentication perpetually**

# Core Technology

## Modular Building Blocks

Device ID.  
Device Trust &  
Telemetry  
Web, Mobile & Workstation



### Low Friction Smart MFA

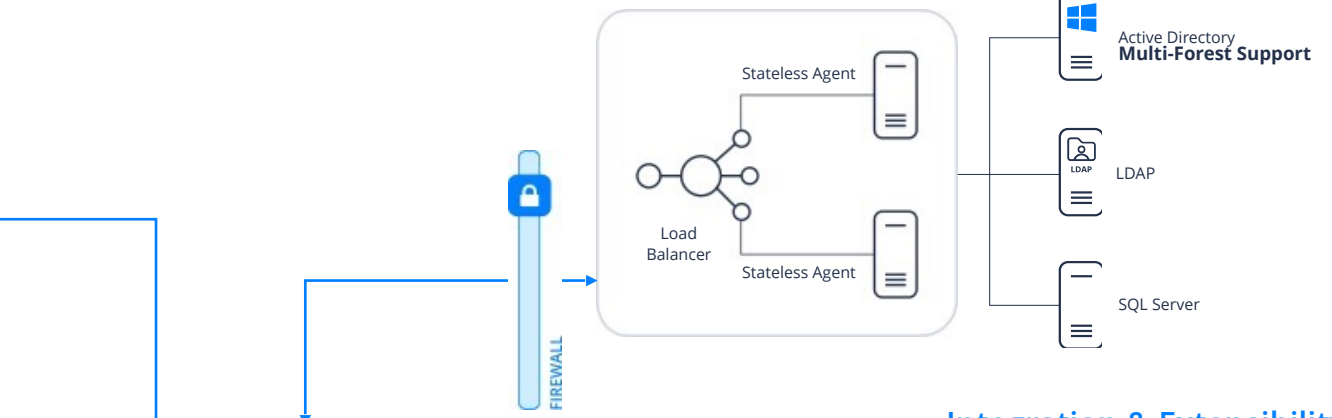
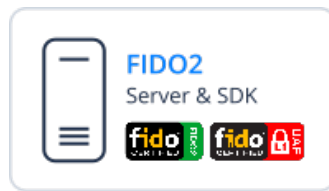

**Integration & Extensibility**  
Enterprise AD/User Dir.  
REST API, Call Center Integration  
Smart MFA & PACS(HID et al)

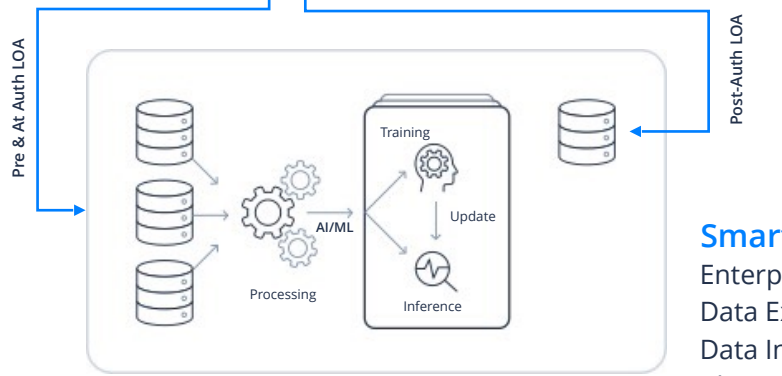
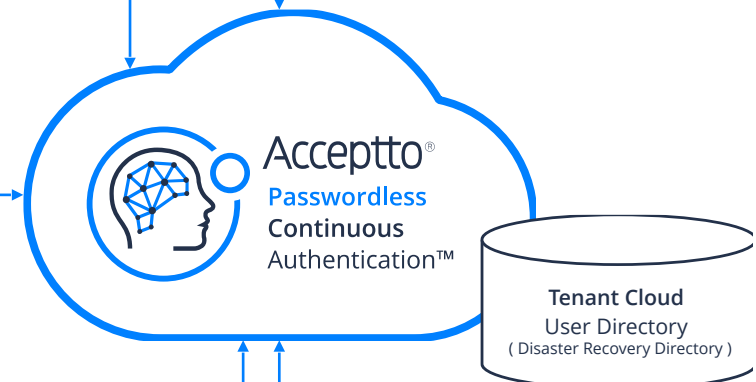

**Smart Data Hub**  
Enterprise & 3rd Party  
Data Exchange  
Data Intelligence and  
Identity Analytics

# Next Gen Authentication Checklist:

Passwordless Continuous Authentication: Zero Trust + Frictionless + Privacy + Compliance & Audit

- **Continuous derived credentials**

- Binded mobile devices, browsers and workstations
- Behavioral analytics
- Edge biometrics

- **Data Science approach for both streaming and batch analysis**

- Pluggable 3rd-party ML risk engines
- Omni data sources - Acceptto, enterprise, 3rd-party

- **User device management - agents, APIs / SDKs**

- **Interoperability / future-proofing (e.g. FIDO-WebAuthn)**

- **Enterprise signal-to-noise ratio configurability (friction vs. control)**

- Zero False Positive (single false positive means breach)
- Throttle false negatives: 0.0005%-0.002% (False Negatives = Unwarranted Step-Up"
- Dynamic Level of Assurance (DLOA) Is Key

- **Embedded Policy Orchestration**

# How Easy Is It To Transition From Password to Passwordless?

```
demo_app > _init_.py > ...  
1 MFA_ON = True  
2 PASSWORDLESS = True  
3
```

```
templates > login.html > form#login-form  
1 {% extends "login-template.html" %}  
2 {% load i18n %}  
3 {{ form.media }}  
4 {% block content %}  
5 <form action="{% app_path %}" method="post" id="login-form"> {% csrf_token %}  
6 <!-- <div class="w-full text-center mt-2 overflow-hidden">  
7   
8 <h3 class="blue text-lg mb-2">Sign in with It'sMe App</h3>  
9 <p class="text-xs">Scan QR code using It'sMe app to sign in</p>  
10   
11 </div>  
12 <hr class="mb-2 mt-2 border-t" /> <div class="mb-4 text-left pb-2 px-4 sm:px-8 ">  
13 <div class="border-l-4 {{ message.tags }} text-left text-xs py-2 px-2" role="alert">  
14 <div class="border-l-4 {{ message.tags }} text-left text-xs py-2 px-2" role="alert">  
15 <div class="border-l-4 {{ message.tags }} text-left text-xs py-2 px-2" role="alert">  
16 <div class="border-l-4 {{ message.tags }} text-left text-xs py-2 px-2" role="alert">  
17 <div class="border-l-4 {{ message.tags }} text-left text-xs py-2 px-2" role="alert">  
18 <div class="border-l-4 {{ message.tags }} text-left text-xs py-2 px-2" role="alert">  
19 <div class="border-l-4 {{ message.tags }} text-left text-xs py-2 px-2" role="alert">  
20 <div class="border-l-4 {{ message.tags }} text-left text-xs py-2 px-2" role="alert">  
21 <div class="border-l-4 {{ message.tags }} text-left text-xs py-2 px-2" role="alert">  
22 <div class="border-l-4 {{ message.tags }} text-left text-xs py-2 px-2" role="alert">  
23 <div class="border-l-4 {{ message.tags }} text-left text-xs py-2 px-2" role="alert">  
24 <div class="border-l-4 {{ message.tags }} text-left text-xs py-2 px-2" role="alert">  
25 <div class="border-l-4 {{ message.tags }} text-left text-xs py-2 px-2" role="alert">  
26 </div>  
27 </form>  
28 <script type="text/javascript">  
29 $((() => {  
30 <script type="text/javascript">  
31 let uid = "{% app_uid %}";  
32 let callbackUrl = "{% url %}";  
33 let faye = new Faye.Client("https://faye.acceptto.com/faye");  
34 let hex1 = Math.floor(Math.random()*16777215).toString(16);  
35 let hex2 = Math.floor(Math.random()*16777215).toString(16);
```

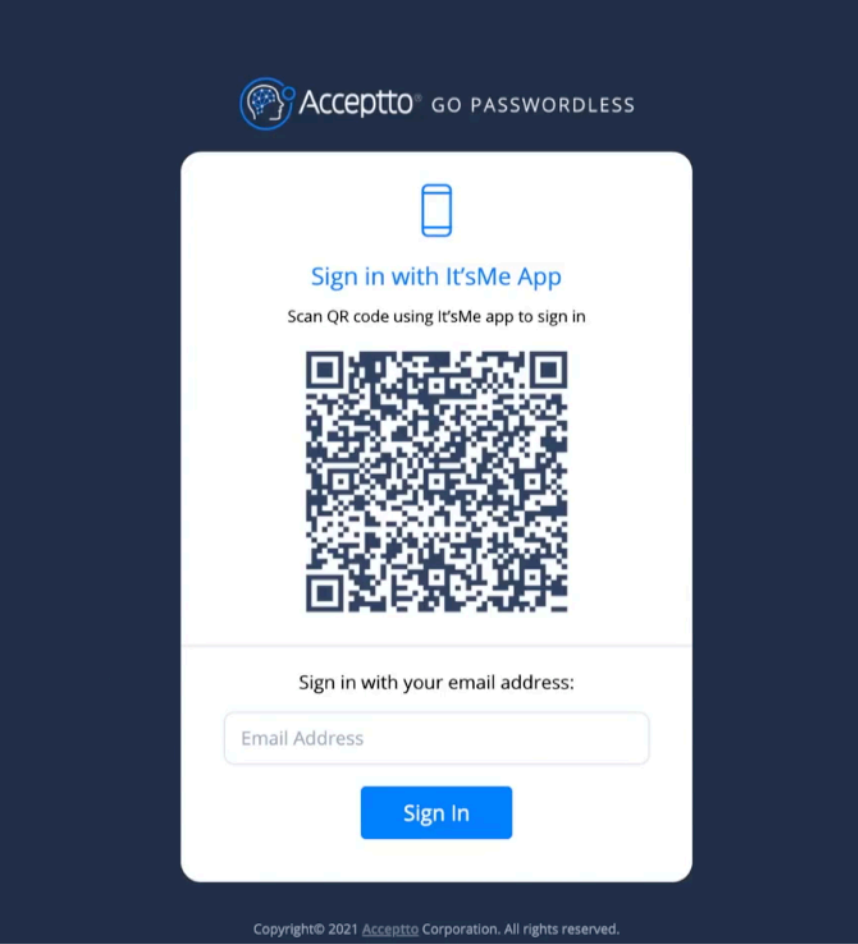

[Easy Configuration : Go Passwordless Web In 3 Mins](#)

# Passwordless With Intelligent MFA UI/UX

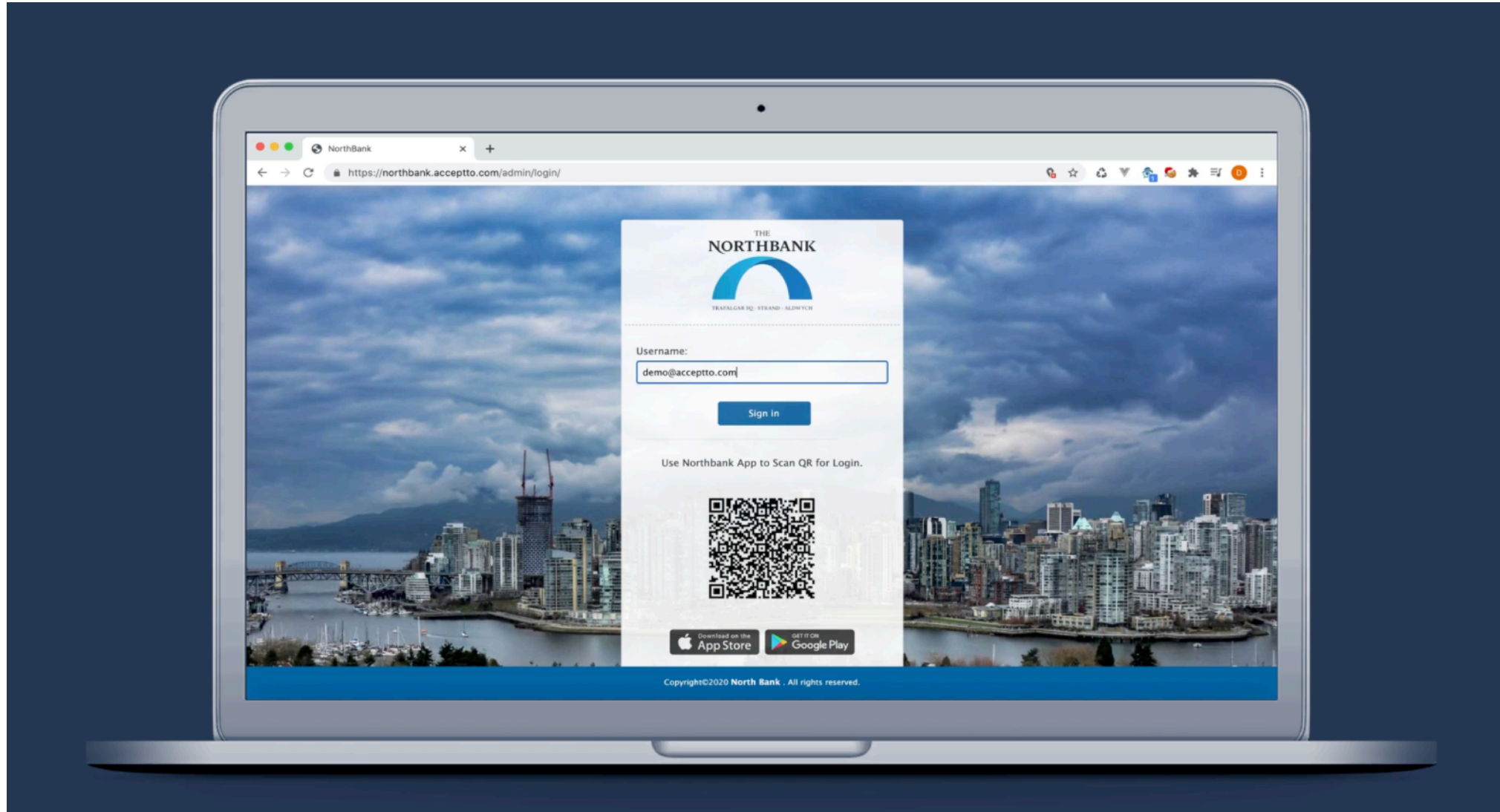

# Realtime Risk Score & Audit From End-Point To SaaS App!

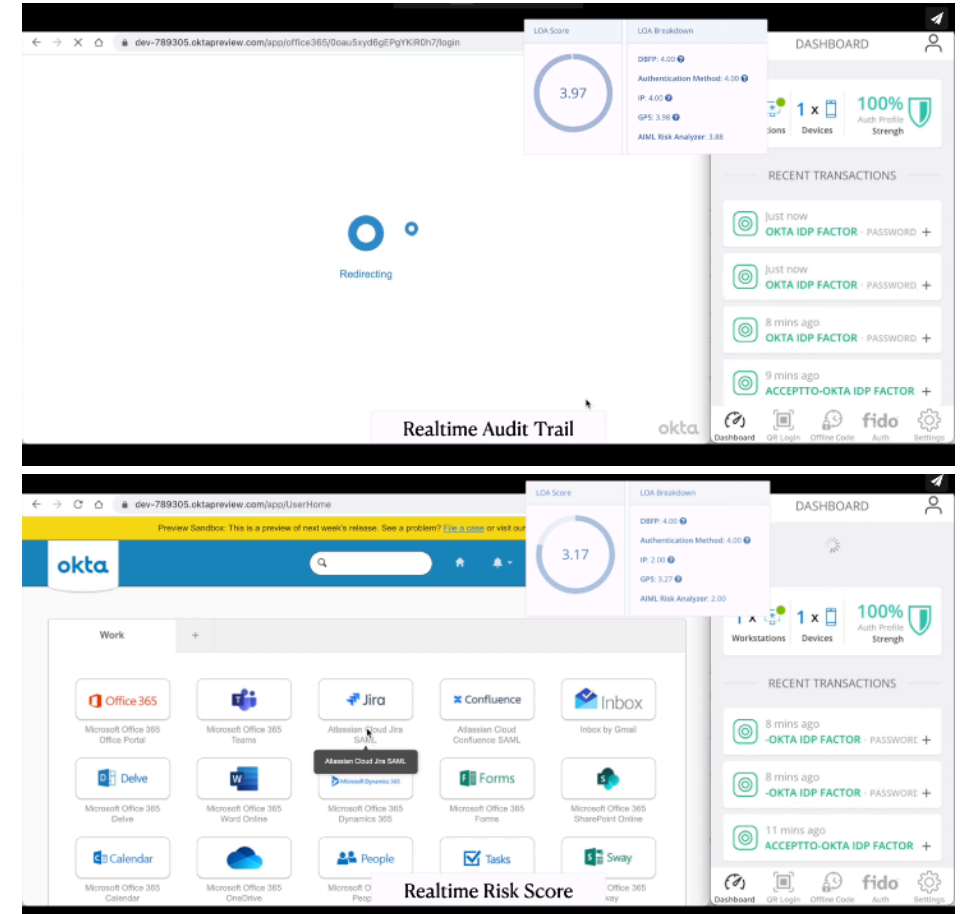
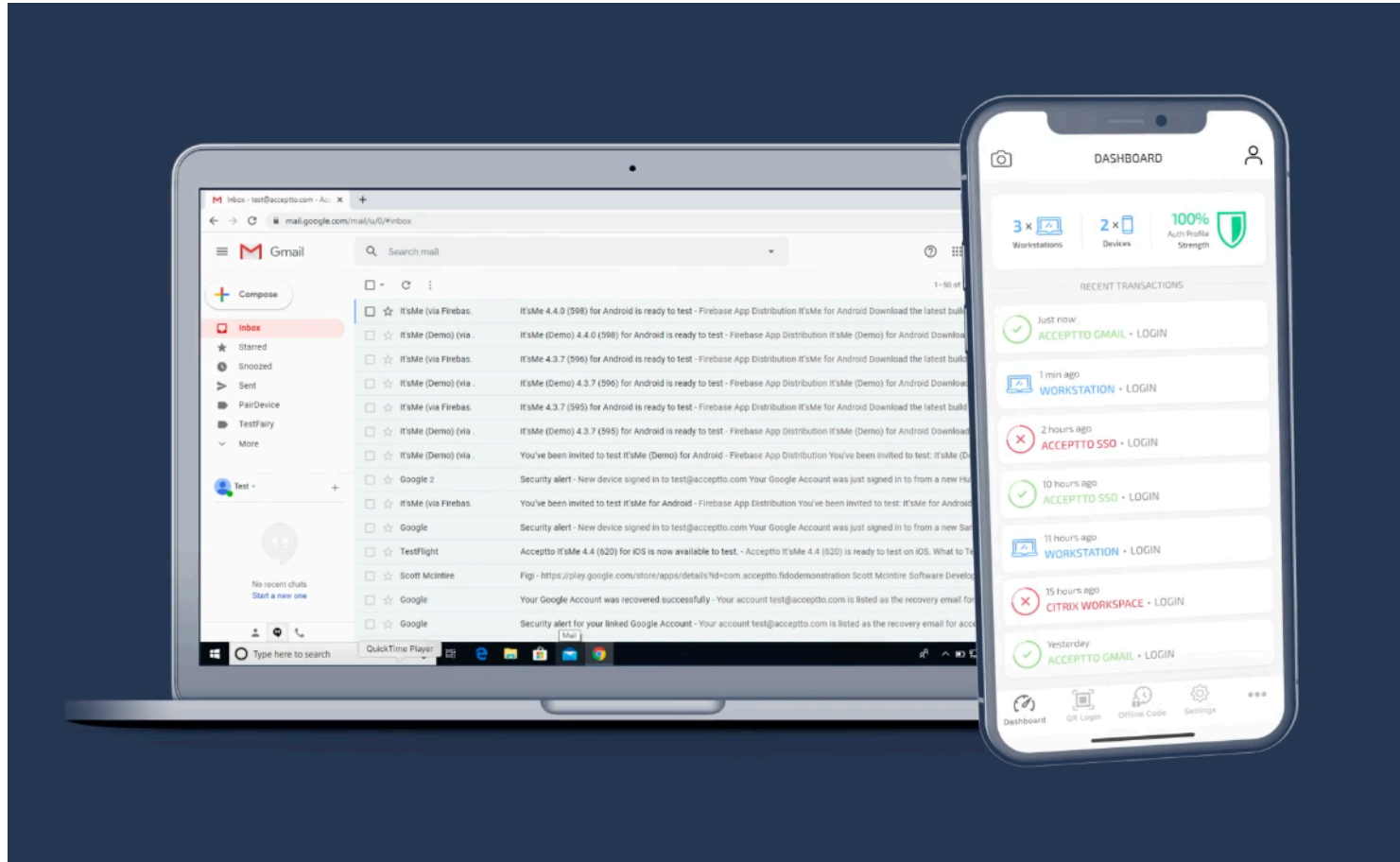

[Workforce Passwordless Continuous Auth + Passwordless SSO](#) including [3rd Party SSO](#), with [3rd Party-Dynamic Risk Score](#) .Easy [3RD Pary Integration](#). [Sim Swap](#) detection



# Can I go Passwordless everywhere (Mobile, Web, Workstation, SSO,...)

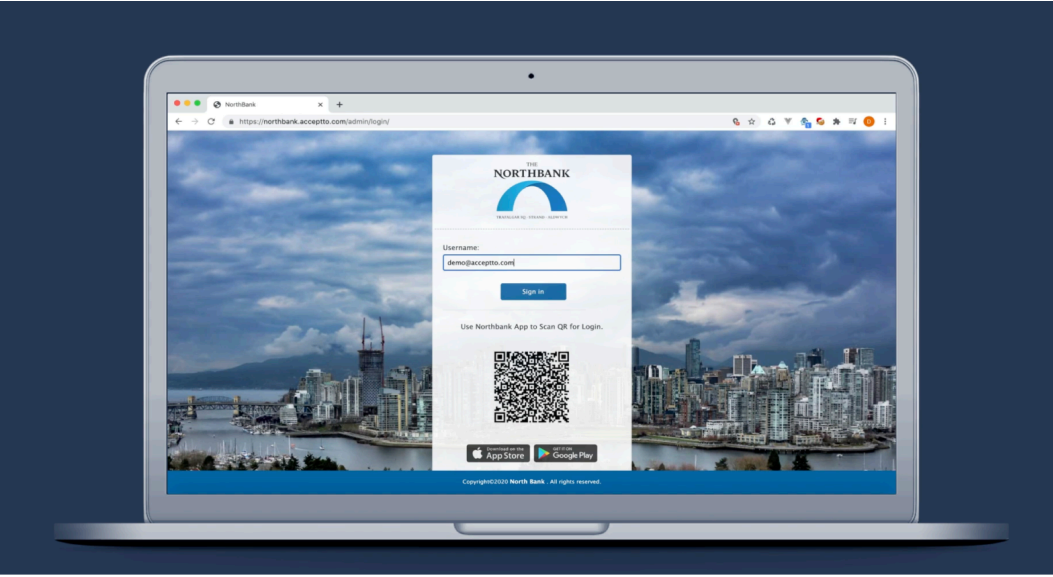
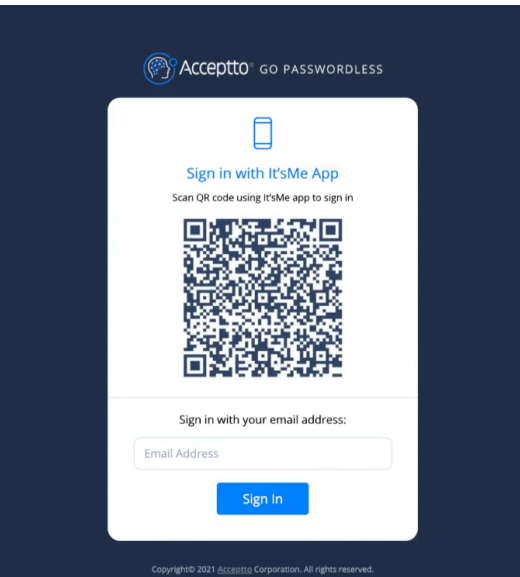
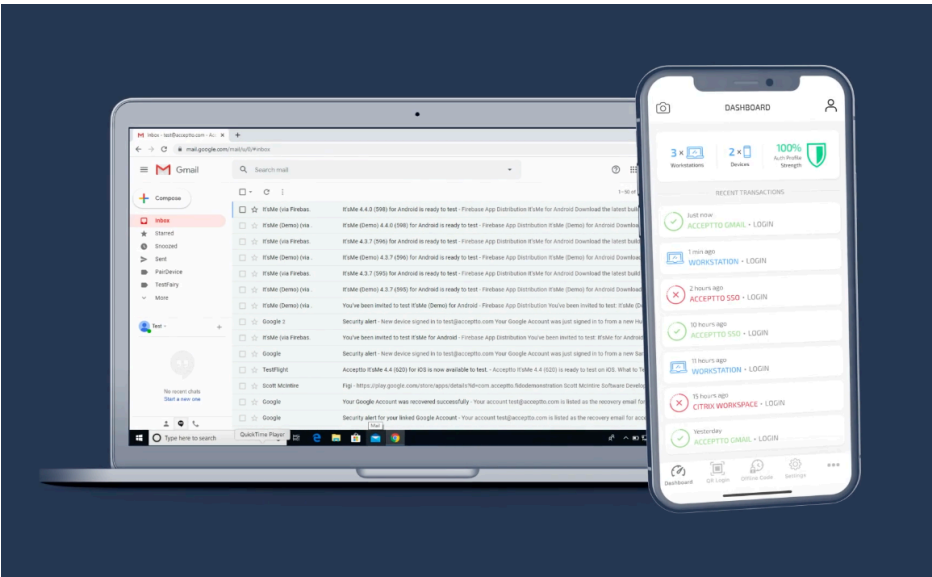

Workforce Passwordless Continuous Auth + Passwordless SSO

Easy Configuration : Go Passwordless Web In 3 Mins

CIAM: Passwordless Context-Aware Web Login

# How Does Continuous Auth Work For Offline/Prox Logins?

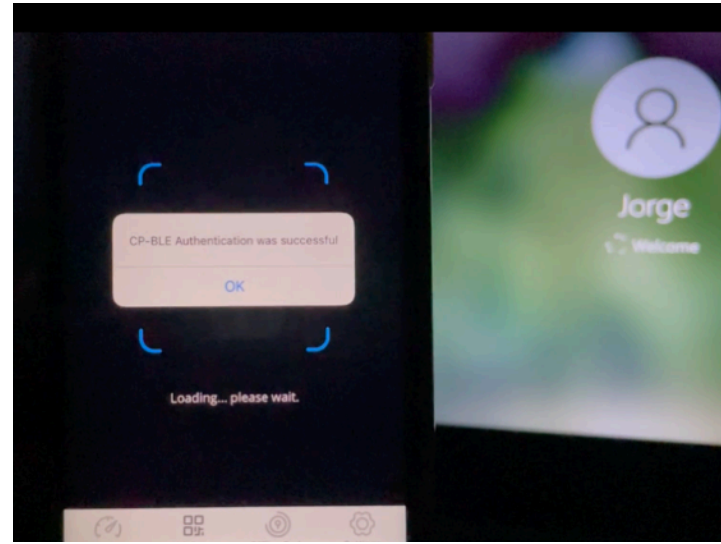
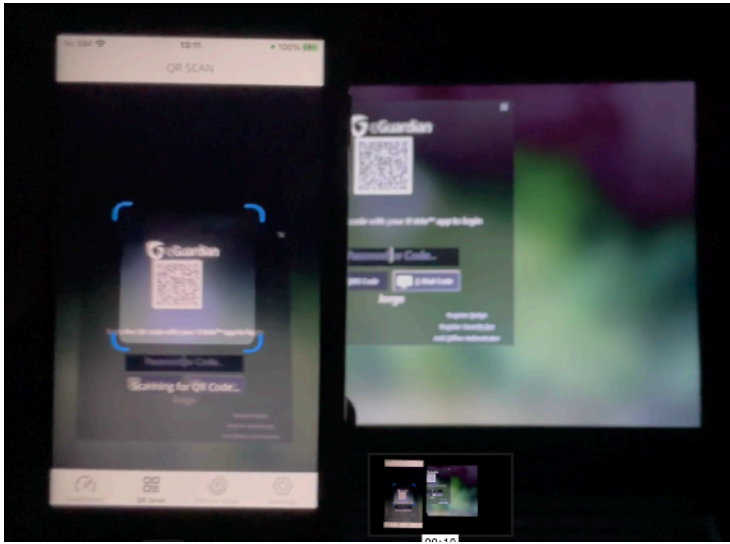

[Passwordless Login to SAMLed app \(e.g. Citrix\) using QR + WebAuthn \(Biometric, Ble, Security Key\).](#)

[Passwordless QR Scan+Ble Auth login to any workstations](#) (Note QR factor can be replaced with any other factors, e.g. Push to initiate the Ble Proximity check)

Risk-Based Factor Sequencing to unlock Workstation [QRE+BLE>Hello+Password/Passphrase](#)

Risk-Based [Factor Sequencing to unlock Workstation and subsequent login to SAMLed app \(e.g. Citrix\) using QR-Ble + Hello + Password Auth.](#)

# How easy is it for users to enable Passwordless Mobile?

Origin Auth Starting Point	Authenticators <i>Something You Are</i>	Implementation Method
Mobile App	PIN <i>Something You Know</i>	Mobile app with Acceptto FIDO2 SDK
	Phone Biometric <i>Something You Are</i>	

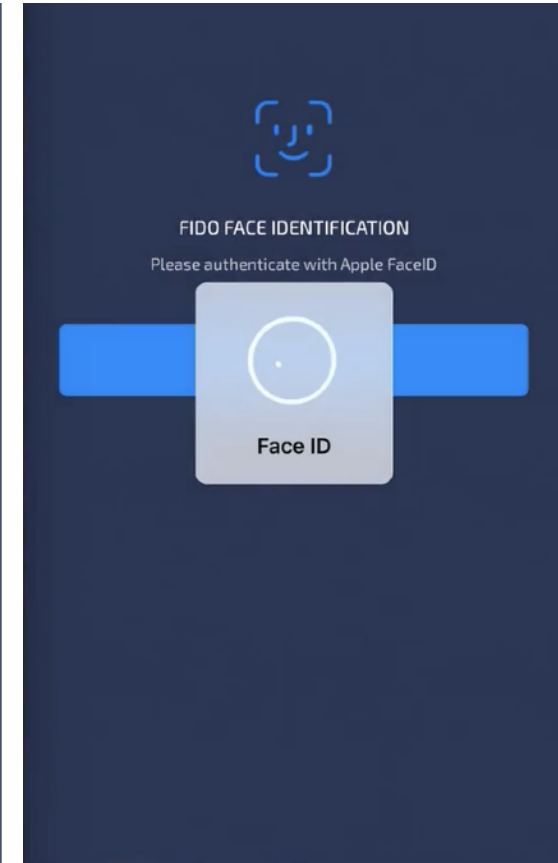
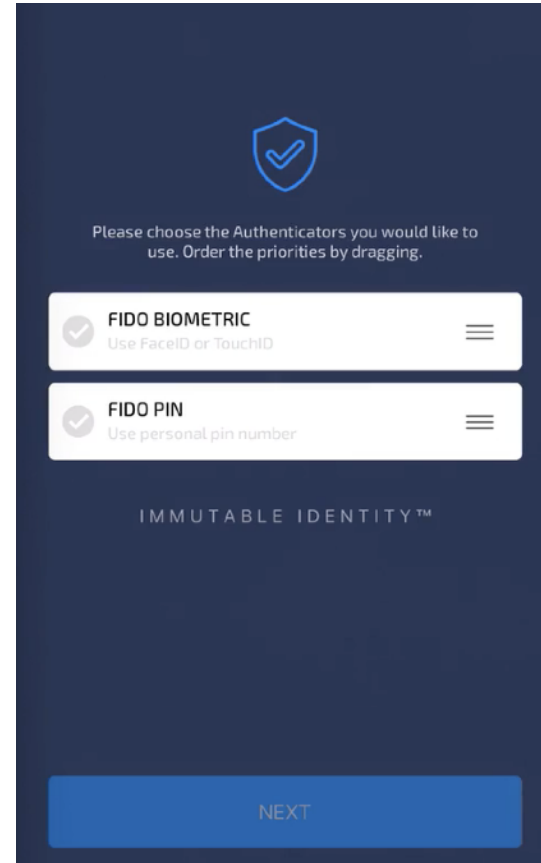

- SDK & FIDO Servers are FIDO WebAuthn Certified
- SDK Manager Supports Easy App Integration
  - Key management with secure storage
  - Authenticator user preferences & ordering
  - Registration/Authentication selection
- One-call solution
  - Full registration/authentication process, yet fully customizable

[FIDO SDK Integration Demo App](#)

# SMS has a set of vulnerabilities including the ultimate ATO via SIM-SWAP? Do you protect against SIM-SWAP?

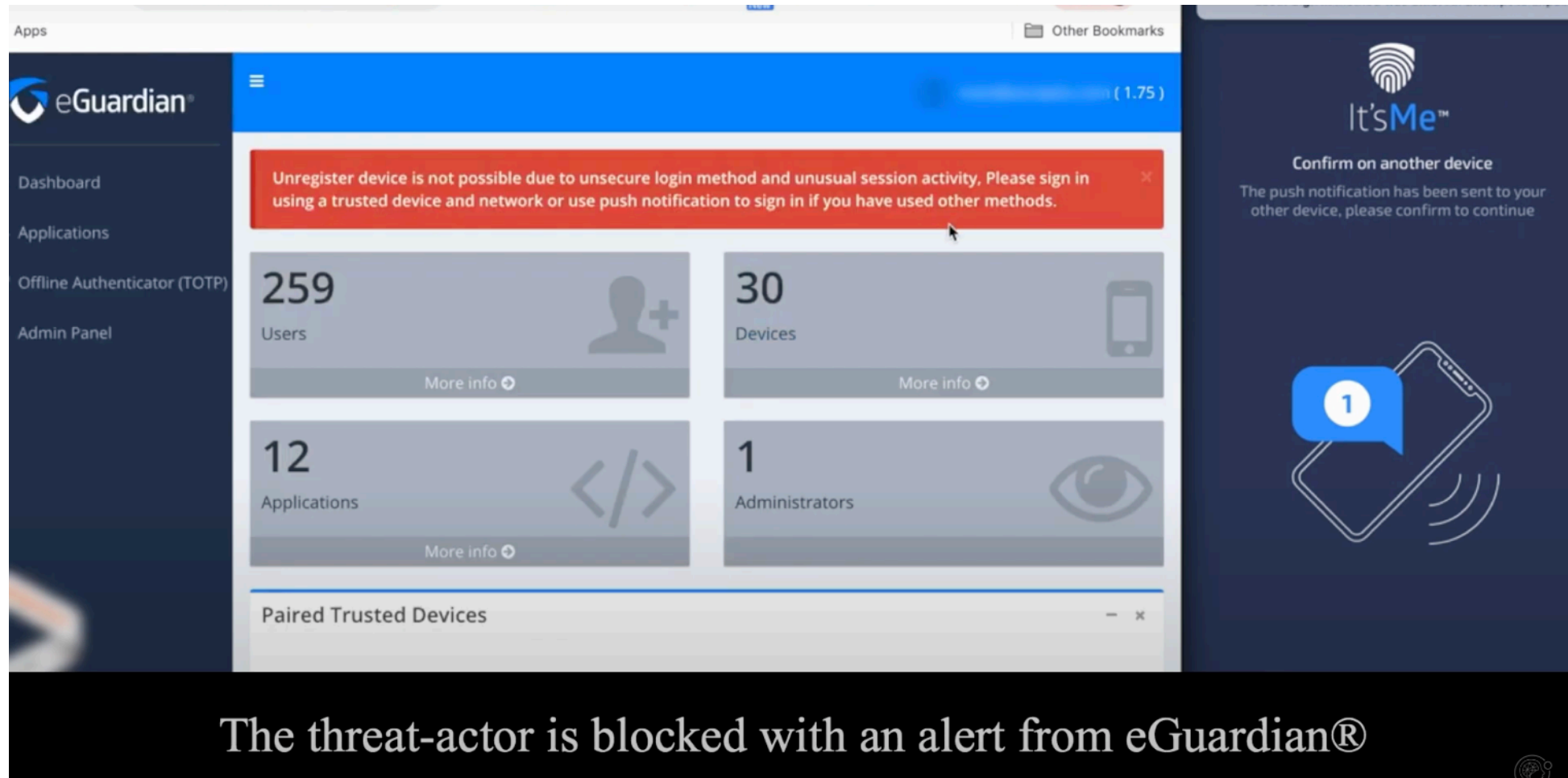

The image shows a screenshot of the eGuardian dashboard on the left and a mobile notification from It'sMe on the right. The dashboard features a navigation menu with 'Dashboard', 'Applications', 'Offline Authenticator (TOTP)', and 'Admin Panel'. A red alert banner at the top reads: 'Unregister device is not possible due to unsecure login method and unusual session activity, Please sign in using a trusted device and network or use push notification to sign in if you have used other methods.' Below the alert are four summary cards: '259 Users', '30 Devices', '12 Applications', and '1 Administrators'. A 'Paired Trusted Devices' section is partially visible at the bottom. The mobile notification on the right, from 'It'sMe', says: 'Confirm on another device. The push notification has been sent to your other device, please confirm to continue.' It includes an icon of a smartphone with a notification bubble containing the number '1'.

The threat-actor is blocked with an alert from eGuardian®

# Backup

# Smart Data Hub | Anomaly Detection →

## Authentication

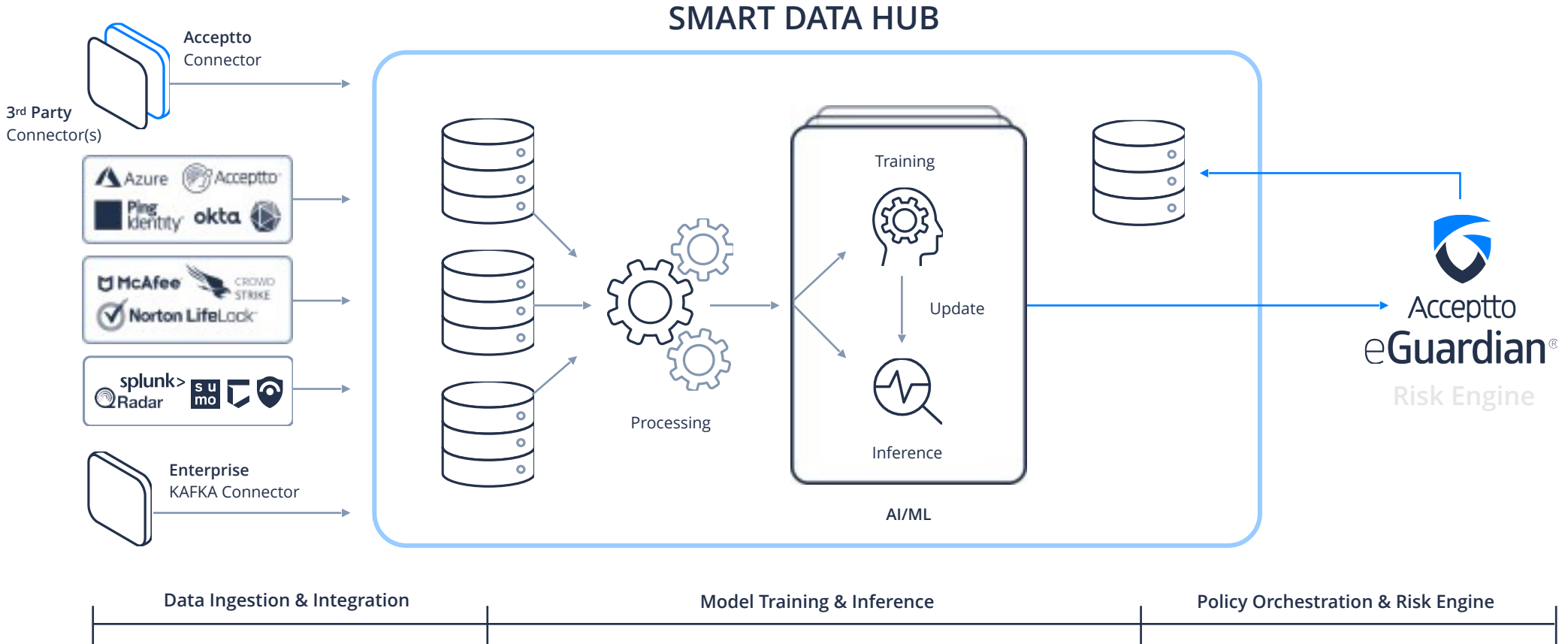

**Ingesting Data From Various Security Tools, Infer & Detect Anomalies:  
Insightful At-Auth & Post-Authorization Actions**

# Unified CIAM-IAM | Passwordless

## Continuous Auth. Solution

IT & Infosec

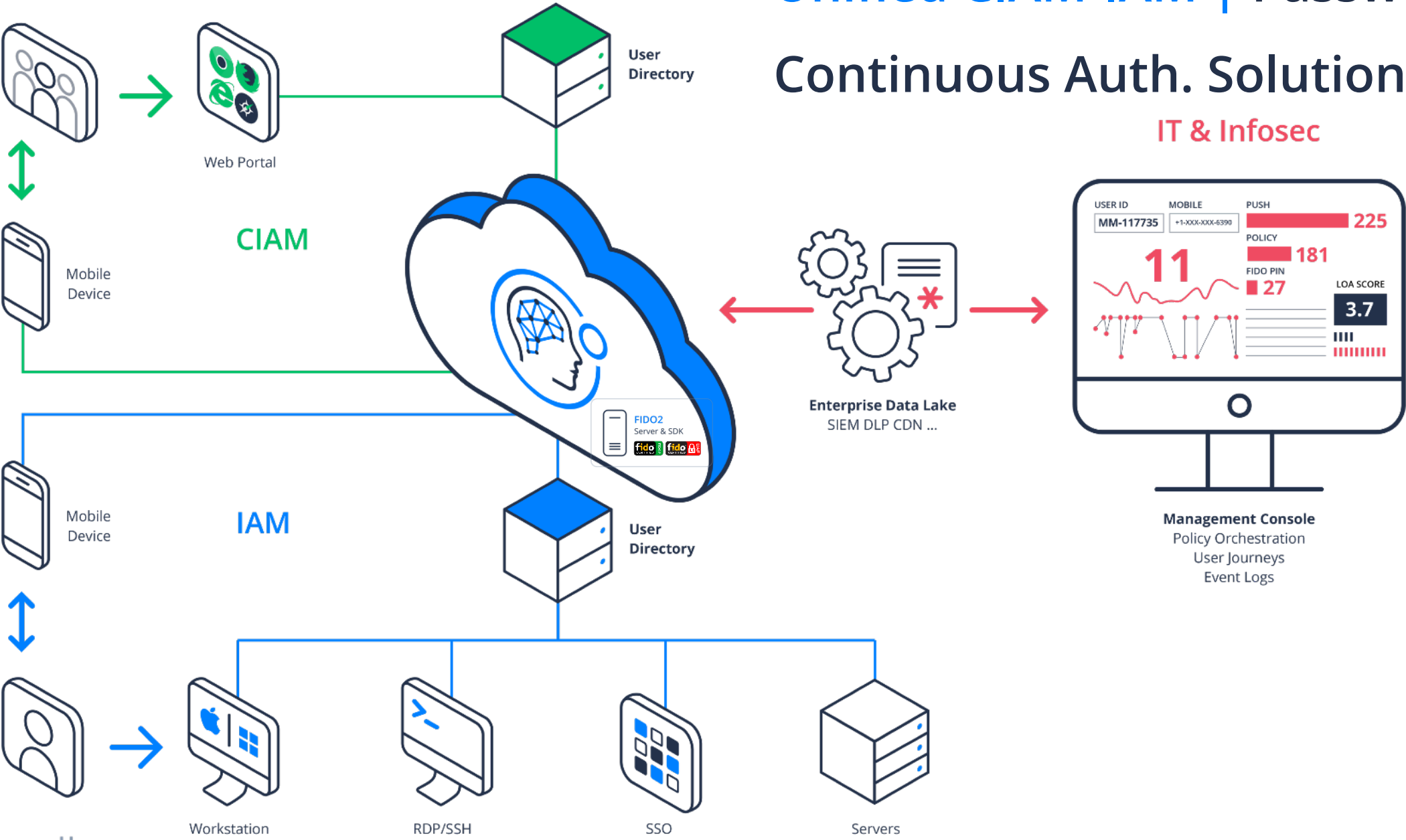

# POLICY ORCHESTRATION: Standard → Advanced → Custom

Acceptto's Policy Engine allows rule-based customization at the user directory level, device level, browser and application (On-Prem or SaaS) level to further adapt to specific needs of each organization and division.

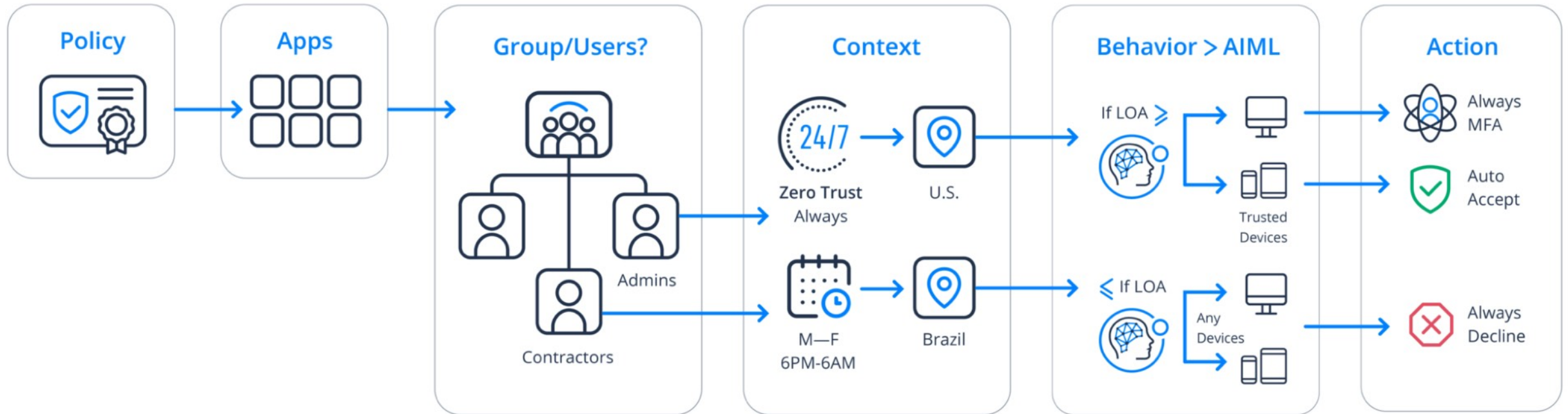



# Passwordless Continuous Authentication Journey

## 1 Enrollment & Life Cycle Management

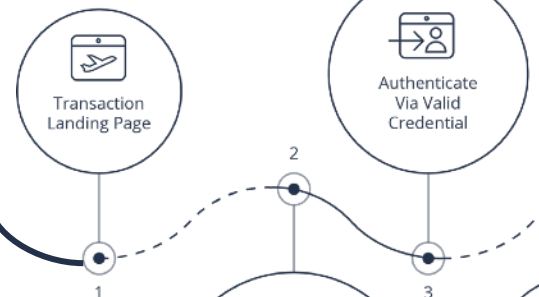
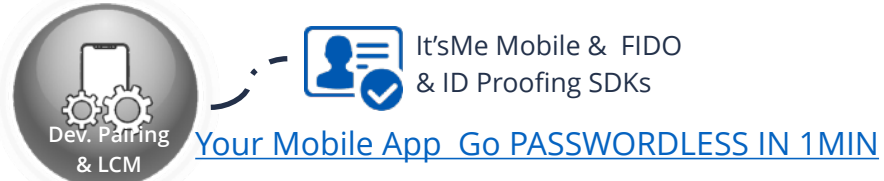

## 2 Device ID: Pre-Auth Intelligence

Dynamic measuring of endpoint risk/health (e.g. Firewall or Bitlocker on-off)

- [Webauthn Sign-In via Win Biometric or TouchID](#)
- [Webauthn Sign-In via YubiKey](#)
- [Webauthn Sign-In via Password or PIN of Mac/Win](#)
- [Passwordless Context-Aware Web Login](#)
- [Easy Configuration : Go Passwordless Web In 3 Mins](#)

## 3 Risk Based: Passthrough vs. Step-Up Auth

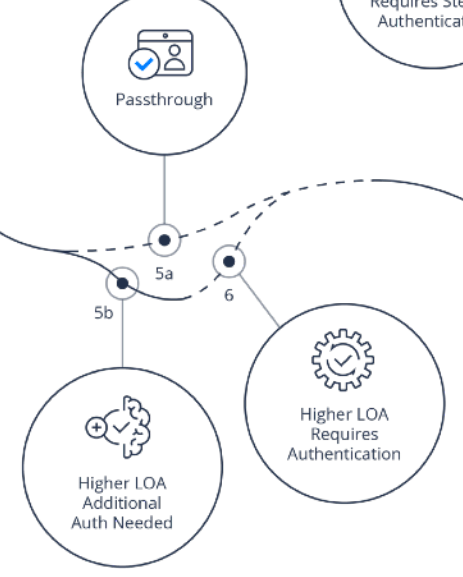

## 4 Continuous Authentication™

Device ID + Device Trust + IDP-SSO

Workforce Passwordless Continuous Auth + Passwordless SSO including 3rd Party SSO, with 3rd Party-Dynamic Risk Score .Easy 3RD Pary Integration. Sim Swap detection

## 5 Smart Data Hub+ Other

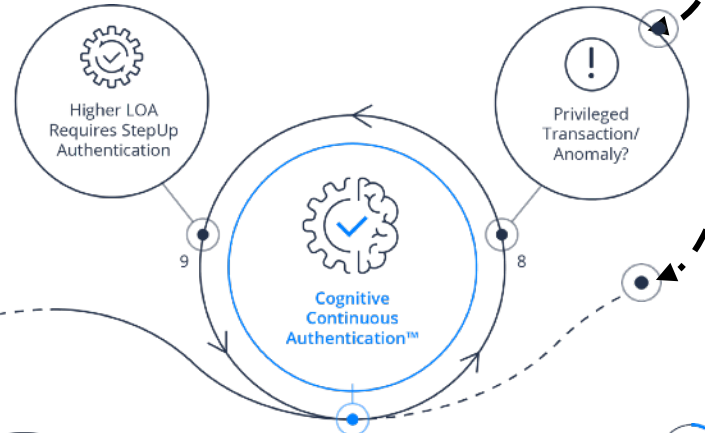

# Configurable Realtime Dashboard

- Single Pane Of Glass
- Zero Trust
- Patented Dynamic Level Of Assurance (DLOA)
- Policy orchestrated & AIML powered
- Full access lifecycle management
- Insightful actions in realtime
- Risk Based
- Continuously
- Including Post-Authorization

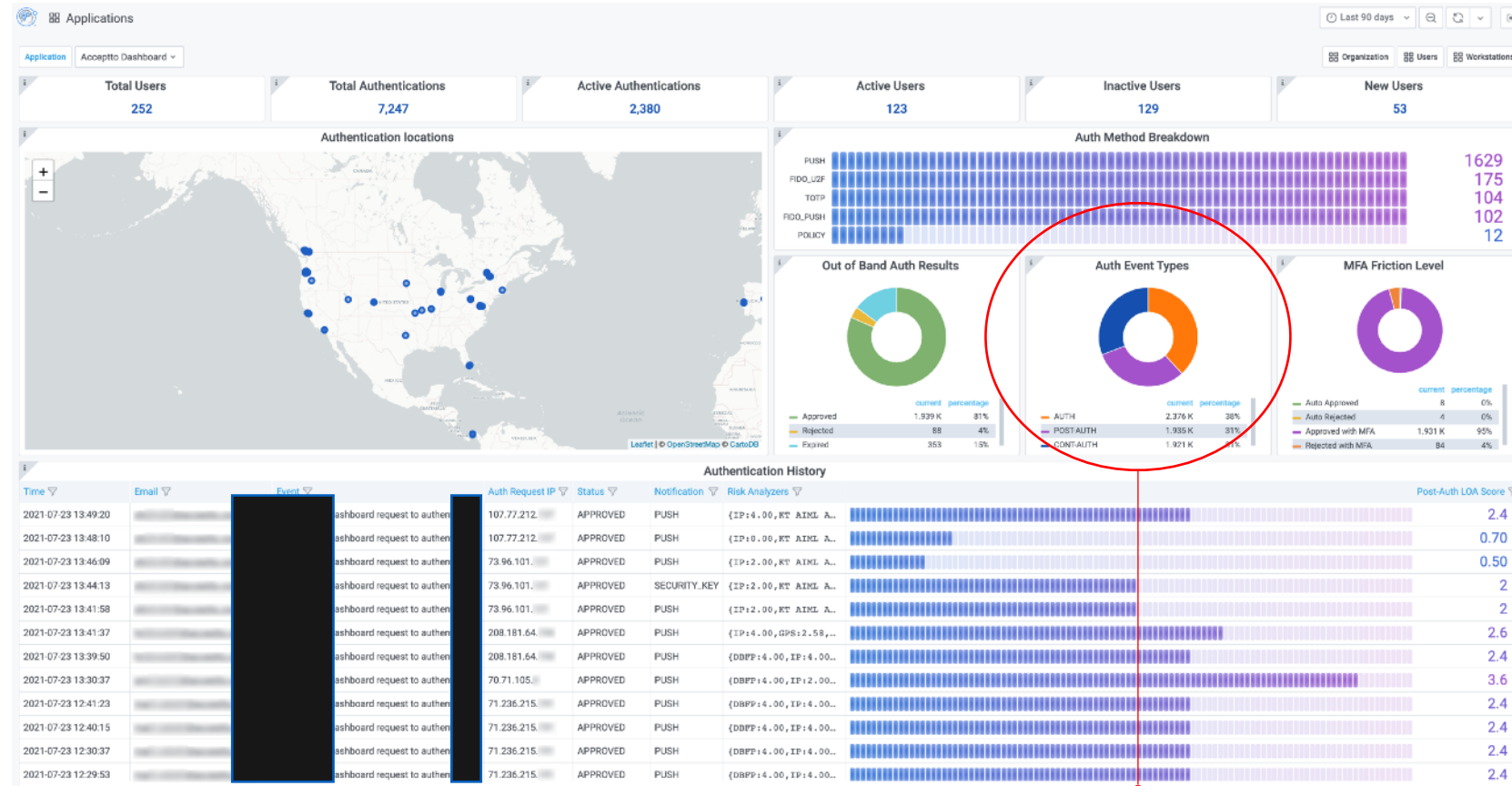

**Patent-backed machine learning algorithms that Enrich the authentication perpetually!**

# Configurable Realtime Dashboard

- Per user & per app LOA Score
- Device Trust (Mac/Win/Terminal Server)
- ▢ Risk Analytics
- ▢ Hygiene
- ▢ Posture change through the session
- Variety Of Risk Analyzer
- ▢ Expandable to enterprise's custom analyzers
- ▢ Integration with 3<sup>rd</sup> party Risk Analyzers

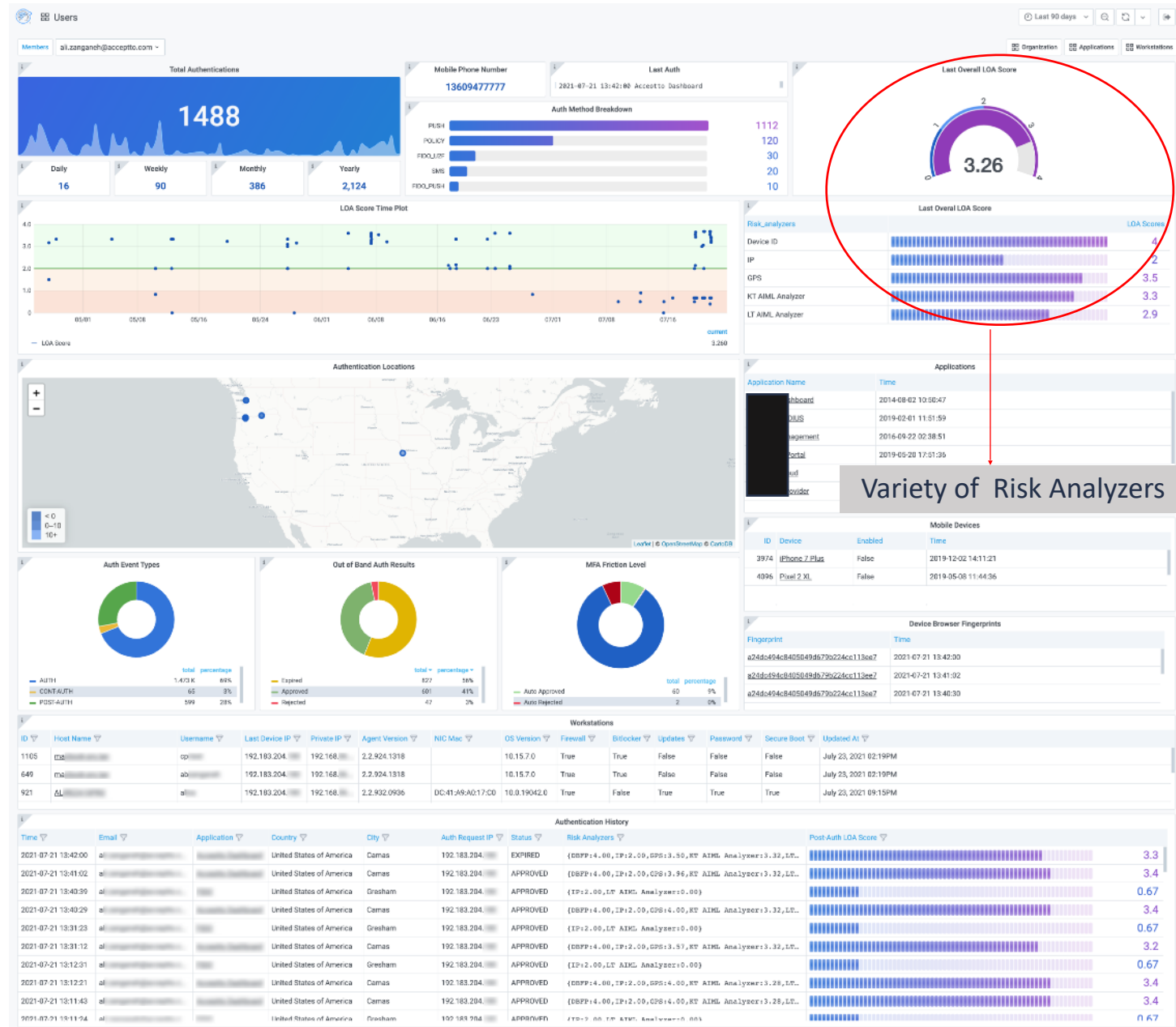

Variety of Risk Analyzers

# Immutable Audit Logs: Bringing SIEM & Device Hygiene to the edge



## Workstation Status

Quickly check if any of your workstations is Unlocked

## Color with Reason

Your audit colors will clearly show you what's going on

Pending | Accepted | Rejected | Expired | Log

## + Icons Revised

Distinct icons will provide accurate and fast visual information on what kind of Audit you're checking

## Animations

Simplified and lightning fast animations to visually aid any Pending transactions

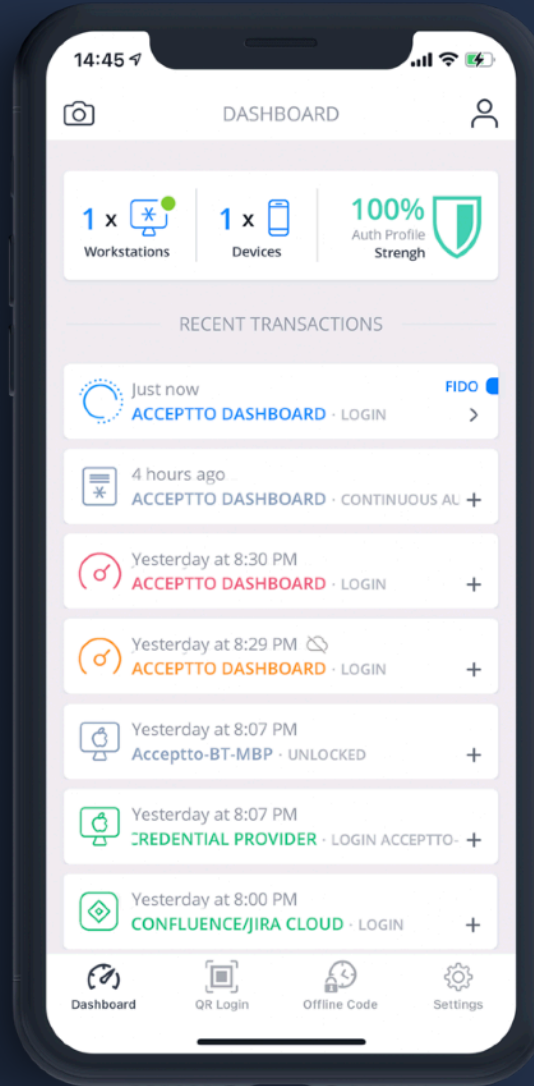

## Logs

New and versatile logs, providing extra information and increasing your audit trails

## Sub-Types

Quickly identify special case transactions for your FIDO or HID interactions.

## Transaction

New Transaction screen will show you all the information you need, using a clean and simple design

## Offline

Easily check if a Transaction was made online or offline



SUBSCRIBE TO UPDATES

# Multi Region

- 5 9's

All Systems Operational

12-Month Core Services Uptime: 99.999%

Uptime over the past 90 days. [View historical uptime.](#)

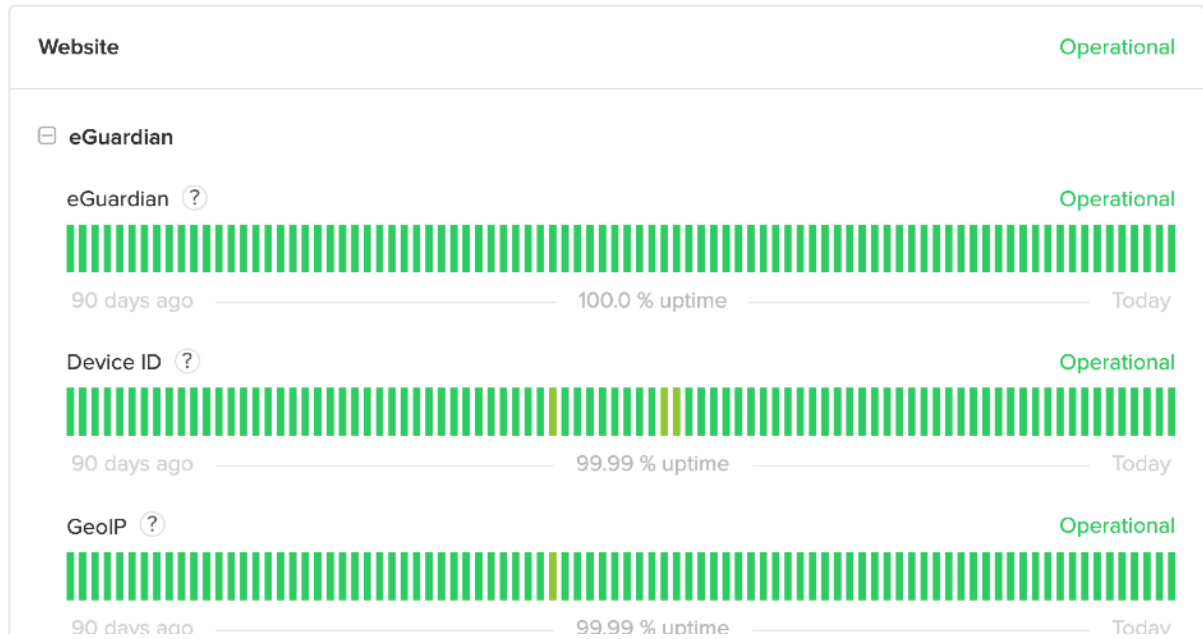

# Rich Online/Offline Authenticators

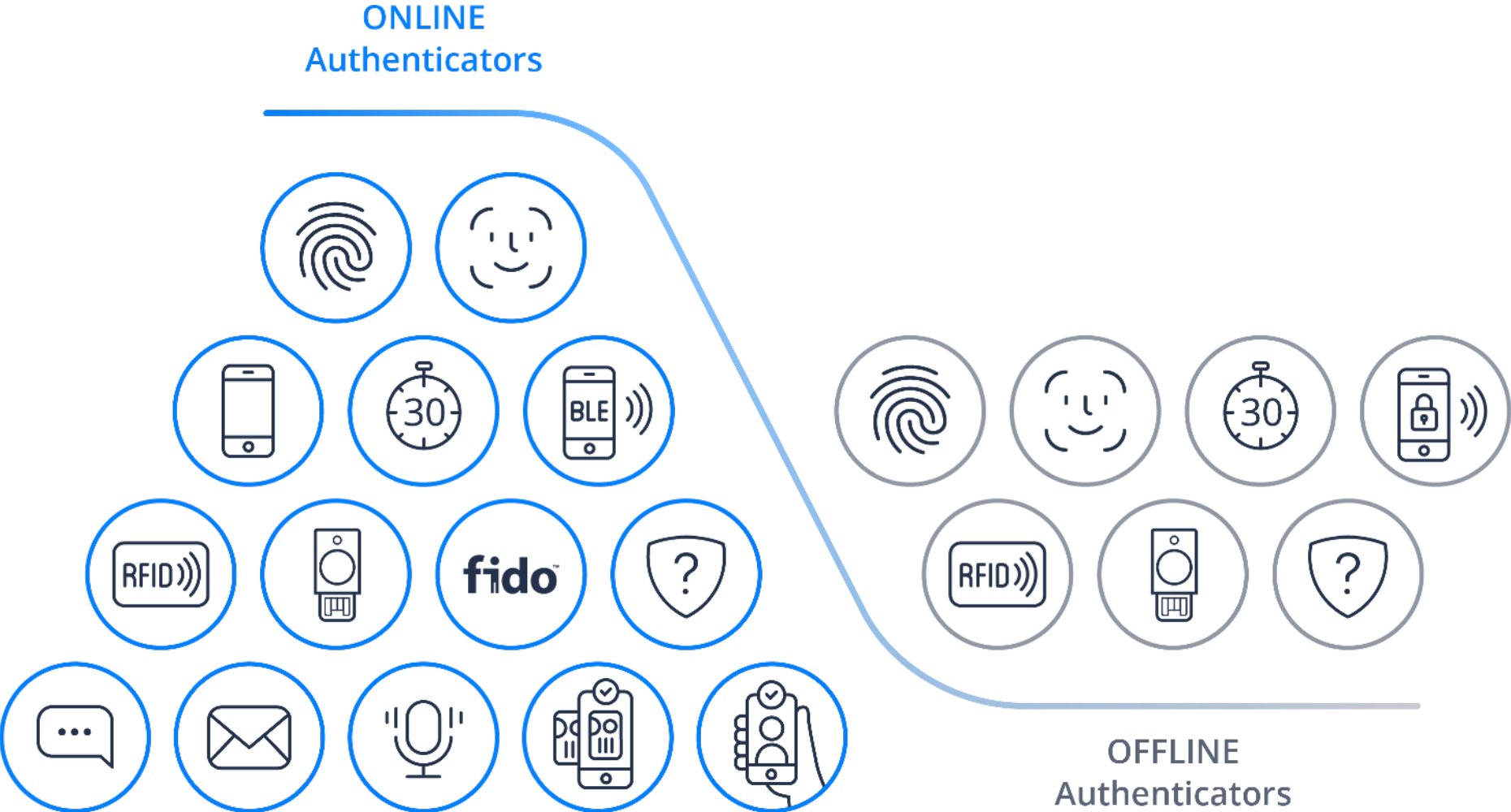

# Online/Offline Authenticators Map

**Connectivity**

- Online
- Offline



	<p>Supported Authenticators Online</p>		<p>Supported Authenticators Offline</p>
	<p>Bypass by Policy + Supported Authenticators Offline</p>		
	<p>Win Hello/Touch ID</p>		
	<p>Always Access Via Offline Modes Even If Enterprise AD Or AWS Down Or Phone Dead</p>		

# CUSTOMER TESTIMONIALS

“Leveraging the Acceptto Authentication Risk Engine, we were able to **achieve and sustain 98% reductions in customer Account TakeOver (ATO) fraud losses.**”

— **Brian Heemsoth**  
Executive Director of Global Security

“**Behavioral-based continuous authentication** uses data science as a foundation for advancements in improving the consumer and employee digital experience, **removing friction and eliminating the potential to misuse credentials.**

**This is the future of digital authentication** as passwords continue to grow in obsolescence, and Acceptto has a platform to provide enterprises with this capability today that offers an **effective implementation approach for every modern enterprise**”

— **Jim Routh**  
Former CISO MassMutual, CVS, Aetna, DTCC & American Express and cyber industry luminary. Current board member Acceptto.

“Acceptto has

- **detected and protected against multiple breach incidents in real-time**
- **made the sensitive admin passwords completely benign** over the last 3 years”

— **John Moore**  
CXO at Wauna Credit Union



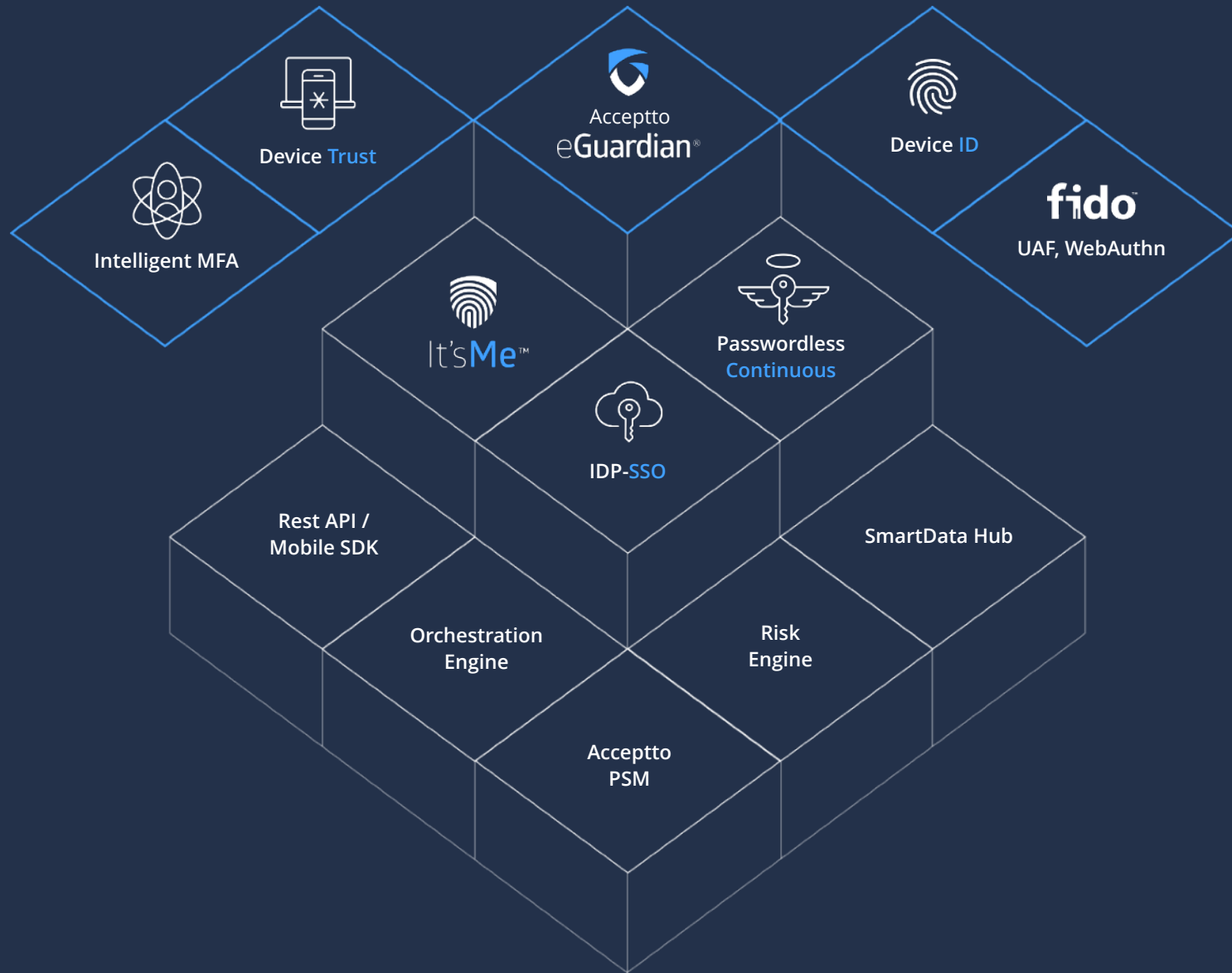

Intelligent MFA

Device Trust

Acceptto  
eGuardian®

Device ID

fido™  
UAF, WebAuthn

It'sMe™

Passwordless  
Continuous

IDP-SSO

Rest API /  
Mobile SDK

SmartData Hub

Orchestration  
Engine

Risk  
Engine

Acceptto  
PSM



Thank You!

Passwordless Continuous Authentication



@Accepttto



[www.accepttto.com](http://www.accepttto.com)



[info@accepttto.com](mailto:info@accepttto.com)